

Machined Steel Wheels – 3/4, 1, 1 1/2, 2 1/2, 3, 3 3/4 Scales



Car Style Wheels

- Precision CNC Machined - Ready To Use
- Made From Low Carbon Steel Bar - Tough Enough to Stand Up to Steel Rail
- Prototype Cross Section - Dished Both Sides
- Axle Hole Undersize by 0.0015 ± 0.0005 for Press Fit
- Used for Freight or Passenger Cars, Leading or Trailing Trucks, or Diesel Locomotives

Specifications

Scale	Tread Width	Flange (outside) Diameter Larger Than Tread Diameter By	Axle Hole
3/4 inch	0.375 inch 9.53mm	0.18 inch 4.6 mm	0.3125
1 inch	0.500 inch 12.70 mm	0.24 inch 6.1 mm	0.3750
1 1/2 inch	0.750 inch 19.05 mm	0.36 inch 9.1 mm	0.6250
2 1/2 inch	1.25 inch 31.75 mm	0.36 inch 9.1 mm	0.7500
3 inch	1.500 inch 38.10 mm	0.72 inch 18.3 mm	1.1250
3 3/4 inch	1.875 inch 47.63 mm	0.36 inch 9.1 mm	1.1250

- Each scale uses IBLS flange profile for that scale except 1.6, 2 1/2 and 3 3/4 scales use 1 1/2 inch scale flanges to operate on 7 1/2 inch gauge track.
- Diameters listed in ordering information are measured where tread meets base of flange.

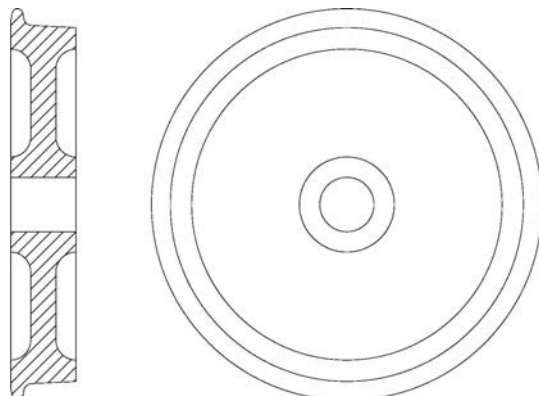

Ordering Information

Stock Number	Description	Cost	Weight	Packing Handling
07W1C	3/4 Inch Scale 33" Wheel, 2.0625" (52.39mm) Diameter	\$15.00	1	
10W1C	1 Inch Scale 33" Wheel, 2.75" (69.85mm) Diameter	\$19.00	1	
10W1D	1 Inch Scale 36" Wheel, 3.0" (76.20mm) Diameter	\$21.00	1	
10W1E	1 Inch Scale 40" Wheel, 3.33" (84.67mm) Diameter	\$24.00	1	
15W1C	1 1/2 Inch Scale 33" Wheel, 4.125" (104.78mm) Diameter	\$27.00	1	
15W1D	1 1/2 Inch Scale 36" Wheel, 4.5" (114.30mm) Diameter	\$31.00	2	
15W1E	1 1/2 Inch Scale 40" Wheel, 5.0" (127.00mm) Diameter	\$34.00	2	
15W1F	1 1/2 Inch Scale 42" Wheel, 5.25" (133.35mm) Diameter	\$38.00	2	
25W1B	2 1/2 Inch Scale 26" Wheel, 5.42" (137.58mm) Diameter	\$58.00	7	
25W1C	2 1/2 Inch Scale 33" Wheel, 6.88" (174.63mm) Diameter	\$72.00	9	
30W1C	3 Inch Scale 33" Wheel, 8.25" (209.55mm) Diameter	\$144.00	21	
37W1A	3 3/4 Inch Scale 22" Wheel, 6.88" (174.63mm) Diameter	\$119.00	15	

Steel Wheels with Hubs

- Precision CNC Machined - Ready To Use
- Made From Low Carbon Steel Bar - Tough Enough to Stand Up to Steel Rail
- Dished On Outer Side with Hub On Inner Side
- Axle Hole Is Sliding Fit - Oversize by 0.0005 ± 0.0005
- Commonly for Diesel Locomotives - Hub Increases Strength in Drive Applications

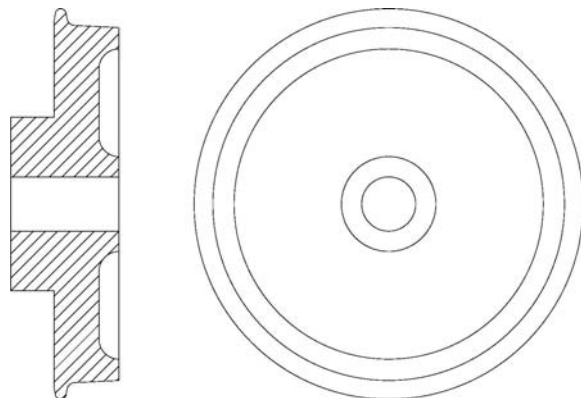

Specifications

Scale	Tread Width	Flange (outside) Diameter Larger Than Tread Diameter By	Axle Hole	Hub Diameter	Hub Width
1 inch	0.500 inch 12.70 mm	0.24 inch 6.1 mm	0.3750	1.5 inches 38.1mm	0.4 inches 10.16mm
1 1/2 inch	0.750 inch 19.05 mm	0.36 inch 9.1 mm	0.6250	2 inches 50.8mm	0.5 inches 12.7mm
2 1/2 inch	1.25 inch 31.75 mm	0.36 inch 9.1 mm	0.7500	2.5 inches 63.5mm	0.6 inches 15.24mm
3 inch	1.500 inch 38.10 mm	0.72 inch 18.3 mm	1.1250	2.5 inches 63.5mm	0.6 inches 15.24mm
3 3/4 inch	1.875 inch 47.63 mm	0.36 inch 9.1 mm	1.1250	2.5 inches 63.4mm	0.6 inches 15.24mm

- Each scale uses IBLs flange profile for that scale except 1.6, 2 1/2 and 3 3/4 scales use 1 1/2 inch scale flanges to operate on 7 1/2 inch gauge track.
- Diameters listed in ordering information are measured where tread meets base of flange.

Ordering Information

Stock Number	Description	Cost	Weight	Packing Handling
10W2C	1 Inch Scale 33" Wheel, 2.75" (69.85mm) Diameter	\$39.00	2	
10W2D	1 Inch Scale 36" Wheel, 3.0" (76.20mm) Diameter	\$44.00	2	
10W2E	1 Inch Scale 40" Wheel, 3.33" (84.67mm) Diameter	\$49.00	2	
15W2C	1 1/2 Inch Scale 33" Wheel, 4.125" (104.78mm) Diameter	\$51.00	3	
15W2D	1 1/2 Inch Scale 36" Wheel, 4.5" (114.30mm) Diameter	\$55.00	4	
15W2E	1 1/2 Inch Scale 40" Wheel, 5.0" (127.00mm) Diameter	\$60.00	4	
15W2F	1 1/2 Inch Scale 42" Wheel, 5.25" (133.35mm) Diameter	\$64.00	5	
25W2B	2 1/2 Inch Scale 26" Wheel, 5.42" (137.58mm) Diameter	\$112.00	9	
25W2C	2 1/2 Inch Scale 33" Wheel, 6.88" (174.63mm) Diameter	\$148.00	10	
30W2C	3 Inch Scale 33" Wheel, 8.25" (209.55mm) Diameter	\$197.00	27	
37W2A	3 3/4 Inch Scale 22" Wheel, 6.88" (174.63mm) Diameter	\$155.00	19	